

# Dimensions for Peerless End Suction Series C Close Coupled Pumps

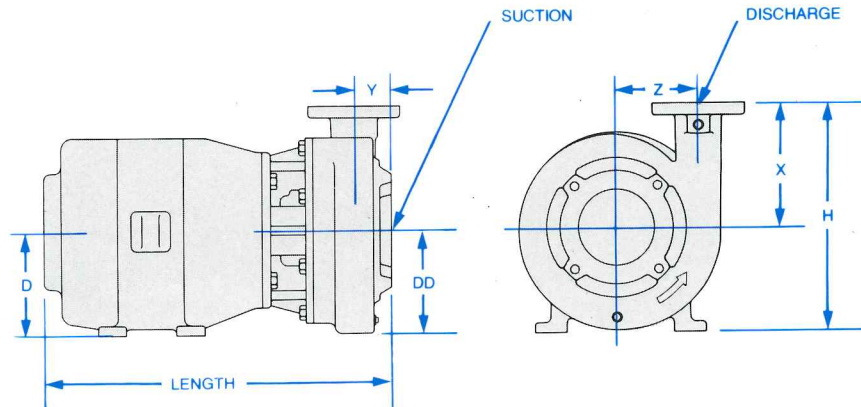

## PUMP DIMENSIONS IN INCHES

Pump Type	Disch.	Suct.	X	Y	Z	D	DD	H*
C610A	1 NPT	2 NPT	4 <sup>3</sup> / <sub>8</sub>	2 <sup>5</sup> / <sub>8</sub>	3 <sup>3</sup> / <sub>8</sub>	5 <sup>1</sup> / <sub>4</sub>	4 <sup>1</sup> / <sub>4</sub>	10
C615A	1 <sup>1</sup> / <sub>2</sub> NPT	2 NPT	5	2 <sup>3</sup> / <sub>4</sub>	3 <sup>3</sup> / <sub>8</sub>	5 <sup>1</sup> / <sub>4</sub>	4 <sup>3</sup> / <sub>8</sub>	10 <sup>1</sup> / <sub>4</sub>
C620A	2 NPT	2 <sup>1</sup> / <sub>2</sub> NPT	5 <sup>3</sup> / <sub>8</sub>	3 <sup>1</sup> / <sub>4</sub>	3 <sup>3</sup> / <sub>8</sub>	5 <sup>1</sup> / <sub>4</sub>	4 <sup>1</sup> / <sub>2</sub>	10 <sup>5</sup> / <sub>8</sub>
C810A	1 NPT	2 NPT	5 <sup>1</sup> / <sub>8</sub>	2 <sup>3</sup> / <sub>4</sub>	4 <sup>3</sup> / <sub>8</sub>	6 <sup>1</sup> / <sub>4</sub>	5 <sup>1</sup> / <sub>4</sub>	11 <sup>3</sup> / <sub>8</sub>
C820A	2 NPT	2 <sup>1</sup> / <sub>2</sub> NPT	6	3 <sup>1</sup> / <sub>8</sub>	4 <sup>5</sup> / <sub>8</sub>	7	5 <sup>1</sup> / <sub>2</sub>	13
C825A	2 <sup>1</sup> / <sub>2</sub> Flg	3 Flg	7 <sup>1</sup> / <sub>4</sub>	2 <sup>1</sup> / <sub>4</sub>	4 <sup>7</sup> / <sub>8</sub>	8	5 <sup>3</sup> / <sub>4</sub>	15 <sup>1</sup> / <sub>4</sub>
C830A	3 Flg	4 Flg	7 <sup>1</sup> / <sub>2</sub>	2 <sup>1</sup> / <sub>8</sub>	5 <sup>1</sup> / <sub>4</sub>	8	6 <sup>1</sup> / <sub>2</sub>	15 <sup>1</sup> / <sub>2</sub>
C840	4 Flg	5 Flg	7 <sup>3</sup> / <sub>8</sub>	3	5 <sup>7</sup> / <sub>8</sub>	5 <sup>1</sup> / <sub>4</sub>	7 <sup>1</sup> / <sub>4</sub>	14 <sup>5</sup> / <sub>8</sub>
C1020A	2 Flg	2 <sup>1</sup> / <sub>2</sub> Flg	7	2 <sup>1</sup> / <sub>2</sub>	5 <sup>7</sup> / <sub>8</sub>	5 <sup>1</sup> / <sub>4</sub>	6 <sup>7</sup> / <sub>8</sub>	13 <sup>3</sup> / <sub>8</sub>
C1025A	2 <sup>1</sup> / <sub>2</sub> Flg	3 Flg	7 <sup>1</sup> / <sub>2</sub>	2 <sup>1</sup> / <sub>4</sub>	5 <sup>7</sup> / <sub>8</sub>	5 <sup>1</sup> / <sub>4</sub>	7	14 <sup>1</sup> / <sub>2</sub>
C1030A	3 Flg	4 Flg	7 <sup>1</sup> / <sub>2</sub>	2 <sup>1</sup> / <sub>8</sub>	6 <sup>1</sup> / <sub>4</sub>	6 <sup>1</sup> / <sub>4</sub>	7 <sup>1</sup> / <sub>2</sub>	15
C1040A	4 Flg	5 Flg	8	2 <sup>7</sup> / <sub>8</sub>	7	6 <sup>1</sup> / <sub>4</sub>	8 <sup>1</sup> / <sub>8</sub>	16 <sup>1</sup> / <sub>8</sub>
C1050A	5 Flg	6 Flg	9	3 <sup>1</sup> / <sub>4</sub>	7 <sup>1</sup> / <sub>8</sub>	6 <sup>1</sup> / <sub>4</sub>	8 <sup>3</sup> / <sub>4</sub>	17 <sup>3</sup> / <sub>4</sub>
C1215A	1 <sup>1</sup> / <sub>2</sub> NPT	2 NPT	7 <sup>1</sup> / <sub>2</sub>	3	6 <sup>3</sup> / <sub>4</sub>	6 <sup>1</sup> / <sub>4</sub>	7 <sup>1</sup> / <sub>2</sub>	15
C1220A	2 Flg	2 <sup>1</sup> / <sub>2</sub> Flg	7 <sup>3</sup> / <sub>4</sub>	2 <sup>1</sup> / <sub>8</sub>	6 <sup>13</sup> / <sub>16</sub>	7	7 <sup>7</sup> / <sub>8</sub>	15 <sup>5</sup> / <sub>8</sub>
C1230A	3 Flg	4 Flg	9	2 <sup>1</sup> / <sub>4</sub>	7 <sup>1</sup> / <sub>8</sub>	7	8 <sup>3</sup> / <sub>8</sub>	17 <sup>3</sup> / <sub>8</sub>
C1240A	4 Flg	5 Flg	9	2 <sup>7</sup> / <sub>16</sub>	7 <sup>1</sup> / <sub>2</sub>	8	9	18
C1250A	5 Flg	6 Flg	9 <sup>3</sup> / <sub>8</sub>	3 <sup>1</sup> / <sub>2</sub>	8	8	9 <sup>3</sup> / <sub>4</sub>	19 <sup>1</sup> / <sub>8</sub>
C1425	2 <sup>1</sup> / <sub>2</sub> Flg	4 Flg	8 <sup>5</sup> / <sub>8</sub>	2 <sup>7</sup> / <sub>8</sub>	7 <sup>3</sup> / <sub>4</sub>	7	8 <sup>1</sup> / <sub>2</sub>	17 <sup>1</sup> / <sub>8</sub>
C1430	3 Flg	4 Flg	8 <sup>5</sup> / <sub>8</sub>	2 <sup>7</sup> / <sub>8</sub>	8	8	9	17 <sup>5</sup> / <sub>8</sub>
C1440	4 Flg	5 Flg	10	2 <sup>7</sup> / <sub>8</sub>	8 <sup>1</sup> / <sub>2</sub>	9	9 <sup>1</sup> / <sub>2</sub>	19 <sup>1</sup> / <sub>2</sub>

\*Maximum pump height (H) includes height from centerline through shaft to bottom of motor or bottom of volute, whichever is greater. Thus...

for Models C610A-C830A, H = X + D

for Models C840-C1440A, H = X + DD

NPT = American standard taper pipe thread.

Flg = Discharge: 125 lb. ANSI; Suction: equivalent to 125 lb. ANSI.

## MOTOR & PUMP DIMENSIONS\*

Horse-power	Length Max.	Width Max.	Approx. Wt., Lbs.
1750 RPM			
1	21	9	100
1 <sup>1</sup> / <sub>2</sub>	22	9	105
2	22	14	166
3	24	14	191
5	24	16	228
7 <sup>1</sup> / <sub>2</sub>	27	16	256
10	28	16	306
15	31	17	377
20	33	18	476
25	33	18	508
30	35	20	589
40	36	20	734
50	38	20	799
60	38	20	812
3500 RPM			
2	21	9	103
3	24	10	130
5	24	11	165
7 <sup>1</sup> / <sub>2</sub>	27	11	235
10	29	11	265
15	31	13	365
20	33	13	435
25	33	14	452
30	34	14	515
40	35	16	640
50	37	16	705

\*Largest pump size used with listed motor.